

## AMPMODU MOD II Shrouded Headers

- Single and double row
- Straight or right angle
- Built-in polarisation and latching
- Gold or tin plated contacts
- 0.63mm square posts

**Specification:**

**Housing** - Black thermoplastic  
UL 94V-0

**Contacts** - Brass (gold plating) or  
phosphor bronze (tin plating)

**Current Rating** - 3A

**Mating Connectors:**

MOD II Receptacle Housings - Page 23



### Single Row Straight

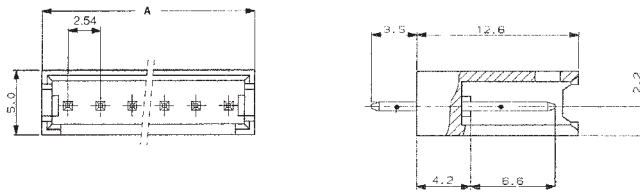

No. of Positions	Dimension A	Part Number	
		0.4µm Gold	Tin
2	7.7	280370-2	280370-1
4	12.7	280371-2	280371-1
6	17.8	280372-2	280372-1
8	22.9	280373-2	280373-1
10	28.0	280374-2	280374-1
15	40.7	280375-2	280375-1

### Single Row Right Angle

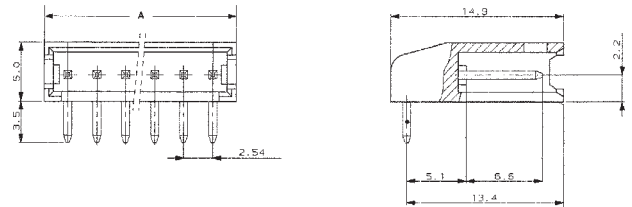

No. of Positions	Dimension A	Part Number	
		0.4µm Gold	Tin
2	7.7	280377-2	280377-1
4	12.7	280378-2	280378-1
6	17.8	280379-2	280379-1
8	22.9	280380-2	280380-1
10	28.0	280381-2	280381-1
15	40.7	280382-2	280382-1

### Double Row Straight

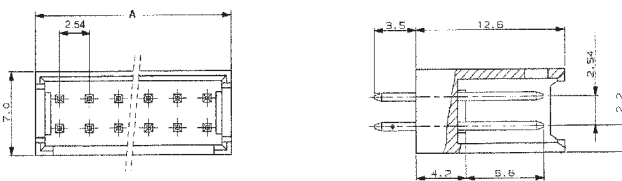

No. of Positions	Dimension A	Part Number	
		0.4µm Gold	Tin
2 x 4	12.7	280384-2	280384-1
2 x 8	22.9	280385-2	280385-1
2 x 12	33.1	280521-2	280521-1
2 x 15	40.7	280387-2	280387-1

### Double Row Right Angle

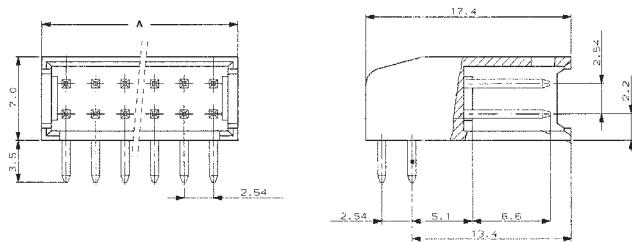

No. of Positions	Dimension A	Part Number	
		0.4µm Gold	Tin
2 x 4	12.7	280389-2	280389-1
2 x 8	22.9	280390-2	280390-1
2 x 12	33.1	280522-2	280522-1
2 x 15	40.7	280392-2	280392-1